

REAL PROJECT SUMMARY

WOOLWORTHS SUPERMARKET – MAROOCHYDORE BIG TOP Refurbishment



WOOLWORTHS SUPERMARKET – MAROOCHYDORE BIG TOP Refurbishment

This Woolworths Supermarket was originally a Franklins Big Fresh store of 4800m² with separate entry and exit areas and a large deli that protruded into the centre of the store. When Woolworths originally took over the store, the original layout remained. This refurbishment relocated every fresh food department to bring the store in line with Woolworths' current layout, and slightly reduced the store size to 4500m². The whole of the Maroochydore Big Top Shopping Centre was being redeveloped at the same time as this refurbishment was being undertaken, requiring integration with Centre services and coordination with the Centre's builder. This refurbishment was undertaken whilst the store remained trading throughout and the program for refurbishment itself ran from January 2015 through to store relaunch in July 2015. The project was brought in on time and more than \$100,000 under budget.

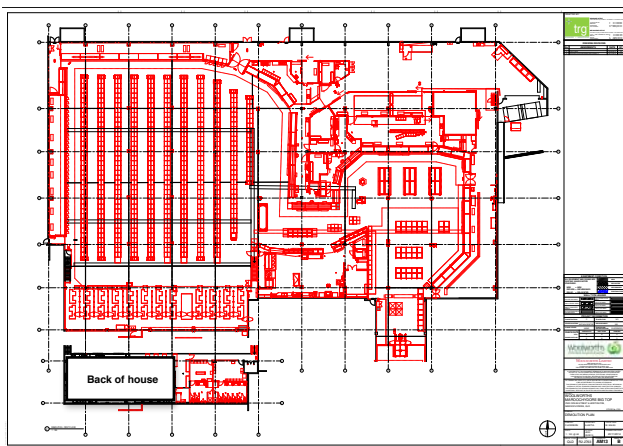

Figure 1: Original layout & extent of demolition

KEY ACHIEVEMENTS / COMPETENCIES:

- The project required a detailed and highly coordinated staging plan.
- Base staging plan was further refined with input from the relay team to ensure customers would still be able to find their tea and coffee!
- Builder had not previously undertaken a Woolworths store refurbishment and required a high level of assistance.
- Complex project dealing with existing and redundant services that had been altered and perished over the previous decades.

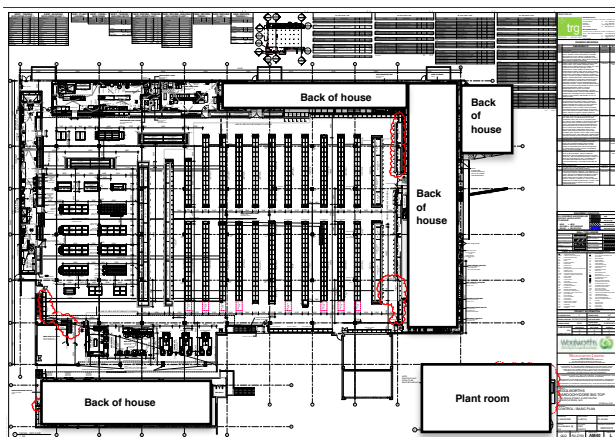

Figure 2: New layout

PROJECT SUMMARY DETAILS

Client – Woolworths Supermarkets

Program – January to July 2015

Value - \$10m

Builder - RCQ